

PERMIT  
 CITY OF NAPOLEON, OHIO - BUILDING DEPARTMENT  
 255 West Riverview Avenue, Napoleon, Ohio 43545 - (419) 592-4010

Permit No. 2450 Issued 9-18-91

Job Location 45 Lemans

Lot 105 Riveria Heights 5th Add.

Issued by Brent N. Damman

Owner Chuck Labie

Address 1305 Glenwood, Napoleon, OH

Agent Beck's Construction Co. 592-8307

Address 11-622 Co. Rd. M, Napoleon

Use Type - Residential XX

Other - Describe \_\_\_\_\_

No. Dwelling Units 1

New xx Replacement \_\_\_\_\_

Add'n. Alter Remodel \_\_\_\_\_

Mixed Occupancy \_\_\_\_\_

Change of Occupancy \_\_\_\_\_

Estimated Cost \$ 78,000.00

FEES	BASE	PLUS	TOTAL
<input checked="" type="checkbox"/> Building	\$ 9.00	\$ 184.00	\$ 193.00
<input checked="" type="checkbox"/> Electrical	\$ 15.00	\$ 54.00	\$ 69.00
<input checked="" type="checkbox"/> Plumbing	\$ 9.00	\$ 27.00	\$ 36.00
<input checked="" type="checkbox"/> Mechanical	\$ 18.00	\$ 6.00	\$ 24.00
<input type="checkbox"/> Demolition	\$	\$	\$
<input type="checkbox"/> Zoning	\$	\$	\$
<input type="checkbox"/> Sign	\$	\$	\$
<input checked="" type="checkbox"/> Water Tap	\$ 375.00	\$	\$ 375.00
<input type="checkbox"/> Sew. Insp.	\$	\$	\$
<input checked="" type="checkbox"/> Sewer Tap	\$ 60.00	\$	\$ 60.00
<input type="checkbox"/> Temp. Water	\$	\$	\$
<input checked="" type="checkbox"/> Temp. Elec.	\$ 10.00	\$	\$ 10.00
TOTAL FEES.....			\$ 767.00
LESS FEES PAID.....			\$
BALANCE DUE.....			\$ 767.00

ZONING INFORMATION

district	lot dimensions	area	front yd	side yd	rear yd
A	80' x 124.86'	9,988.8	30'	7'	15'
max hgt	no pkg spaces	no ldg spaces	max cover	petition or appeal req'd	date appr
35'	2 per		35%		

WORK INFORMATION

Size: Length 58'4" Width 46'4" Stories 1 Ground Floor Area 1802

Height \_\_\_\_\_ Building Volume (for Demo. Permit) \_\_\_\_\_

Electrical: \_\_\_\_\_

Plumbing: \_\_\_\_\_

Mechanical: \_\_\_\_\_

Additional Information: New One (1) Story Home.

Date 9/23/91 Applicant Signature Robert J. Beck

**PAID**  
**SEP 25 1991**  
 CITY OF NAPOLEON



9-30-91

Becks Const  
45 Lemons  
BND

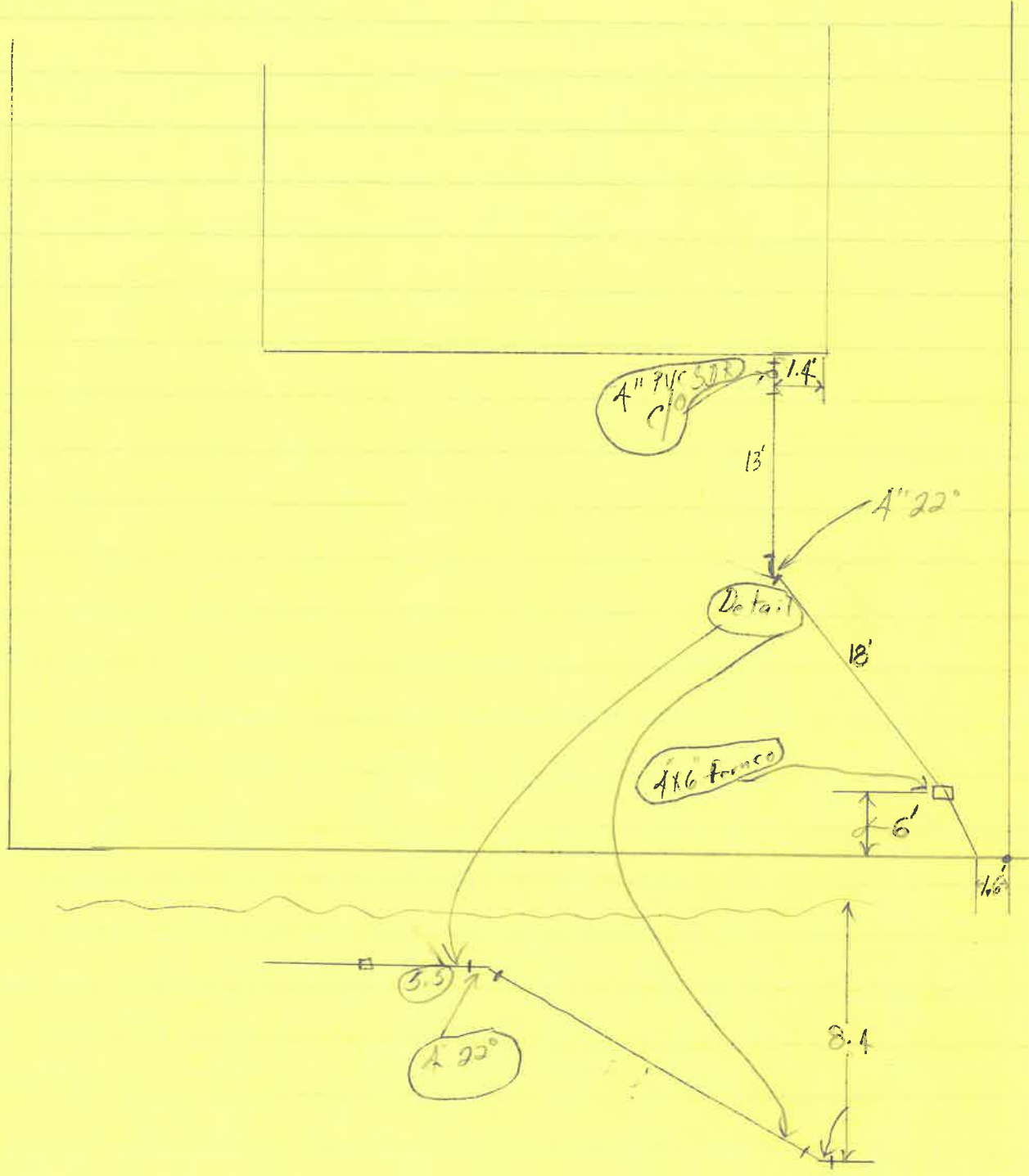



# METER YOKE RELEASE

This document is for the release of one (1) Water Meter Yoke for Residential water service lines.

Lawn Sprinkler yoke 3/4"

RELEASE NO. 0049

PERMIT NO. 301 ISSUED 9-7-93

JOB LOCATION 45 Lemans

- Inside City Limits      ( ) - Outside City Limits

ISSUED BY BND

OWNER Chuck Labie

ADDRESS 45 Lemans

CONTRACTOR Tropical Gardens

ADDRESS 1009 W. High Defiance

CONTRACTOR'S PHONE NO. 704-4101

WATER TAP SIZE:  = 1"      ( ) = 1-1/2"      ( ) = 2"

WATER METER s# \_\_\_\_\_

- New Dwelling      ( ) - Existing Dwelling

Water Service Line to be Type (K) Copper or (CTS) Polyethelene Tubing of one inch (1") minimum.

Watts No. 7 Dual check required  = Yes      ( ) = No

Water Meter Yoke installation is subject to the following conditions:

- 1.) Must be located in an accessible area.
- 2.) Must be in an area not subject to freezing temperatures.
- 3.) Must be eighteen inches (18") above floor level, **not in crawl spaces**, unless circumstances dictate.
- 4.) Must comply with the mounting criteria and clearances as set forth in **DRAWING #04403901**.



APPLICATION  
for  
RESIDENTIAL BUILDING, ELECTRICAL, PLUMBING, MECHANICAL, PERMITS and DEMOLITION PERMIT  
from the

CITY OF NAPOLEON - BUILDING DEPARTMENT

255 West Riverview Ave. Napoleon, Ohio 43545 Pn. 419-592-4010

Entry No. \_\_\_\_\_

Permit No. 2450 Issued 9-18-91

Job Location 45 Lemans

Lot 105 Riviera Hts 5th Add  
sub-div. or legal disc.

Issued By \_\_\_\_\_  
building official

Owner Chuck Labie Pn \_\_\_\_\_

Address 1305 Glenwood

Agent Beck's Const Co Pn 592 8307

Address 11622 Rd M

Description of Use NEW 1.5 story home

Residential 1  
no. dwelling units

Commercial \_\_\_\_\_ Industrial \_\_\_\_\_

New  Add'n. \_\_\_\_\_ Alter \_\_\_\_\_ Remodel \_\_\_\_\_

Mixed Occupancy NO

Change of Occupancy NO

Estimated Cost \$ 78,000

Chk.	Permits Reg.	Base	Fees Plus	Total
<input checked="" type="checkbox"/>	Building	<u>9.00</u>	<u>184.00</u>	<u>193.00</u>
<input checked="" type="checkbox"/>	Electrical	<u>15.00</u>	<u>54.00</u>	<u>69.00</u>
<input checked="" type="checkbox"/>	Plumbing	<u>9.00</u>	<u>27.00</u>	<u>36.00</u>
<input checked="" type="checkbox"/>	Mechanical	<u>18.00</u>	<u>6.00</u>	<u>24.00</u>
	Demolition	_____	_____	_____
	Zoning	_____	_____	_____
	Sign	_____	_____	_____

Water tap 375.00 375.00

Sewer Tap 60.00 60.00

Temp. Water \_\_\_\_\_

Temp. Elec. 10.00 10.00

Additional struc. \_\_\_\_\_ hrs

plan review Elect. \_\_\_\_\_ hrs

Total Fees..... 767.00

Less Min. Fees Pd. \_\_\_\_\_

Balance Due..... 767.00

**ZONING INFORMATION**

district	lot dimensions	area	front yd	side yds.	rear yd
<u>A</u>	<u>80 X 124.86</u>	<u>9988.8</u>	<u>30</u>	<u>7</u>	<u>15</u>
max hgt	no pkg spaces	no ldg spaces	max cover	petition or appeal req'd.	date appr
<u>35'</u>	<u>2 per</u>		<u>35%</u>		

**WORK INFORMATION:**

BUILDING: Garage Fl. Area 484 Basement Fl. Area \_\_\_\_\_ Second Floor Area \_\_\_\_\_

Size: Length 58' 4" Width 46' 4" Stories 1 Ground Floor Area 1802

Height \_\_\_\_\_ Building Volume (for deas. permit) \_\_\_\_\_ cu. ft.

Description of Work: New 1 Story

Continue on Back Side for Electrical, Plumbing and Mechanical and other Information;

**ELECTRICAL: Electrical Contractor** Buck's Const Co Pn. 593-8307  
 Address 11622 Rd M Nap. O. Estimated Cost \$ \_\_\_\_\_  
 Type of work: New  Service change \_\_\_\_\_ Rewiring \_\_\_\_\_ Additional Wiring \_\_\_\_\_  
 Size of service 200 Underground  Overhead \_\_\_\_\_ No. of new circuits 18  
 Description of work: New

**PLUMBING: Plumbing Contractor** Meyer Pl & HT Pn. 592-7561  
 Address N. Perry St Nap. O. Estimated Cost \$ \_\_\_\_\_  
 Water Tap Req.  Size 1 Type of Pipe \_\_\_\_\_ Water Dist. Pipe Plastic  
 San. Sewer Tap Req.  Size 4" Type of Pipe \_\_\_\_\_ Dr. Waste Vt. Pipe Plastic  
 St. Sewer Tap Req.  Size 4" Type of Pipe \_\_\_\_\_ Street to be Opened   
 Main Building Drain Size 4" Main Vent Pipe Size 4" List Number of Plumbing Fixtures Below  
 Water Closets 1 Bathtubs 1 Showers 1 Lavatories 2 Kitchen Sinks 1 Disposal 1 Dishwasher 1 Clothes Washer 1  
 Floor Drains 0 Other Fixtures: Type \_\_\_\_\_ No. 9  
 Description of Work: New

**MECHANICAL: Mechanical Contractor** Meyer Pl & HT Pn. 592-7561  
 Address N. Perry St Nap. O. Estimated Cost \$ \_\_\_\_\_  
 Heating System: Forced Air  Gravity \_\_\_\_\_ Hot Water \_\_\_\_\_ Steam \_\_\_\_\_ Unit Heaters \_\_\_\_\_ Radiant \_\_\_\_\_ Baseboard \_\_\_\_\_  
 Type of Fuel: Electric \_\_\_\_\_ Natural Gas  Propane \_\_\_\_\_ Wood \_\_\_\_\_ Coal \_\_\_\_\_ Solar \_\_\_\_\_ Geothermal \_\_\_\_\_ Other \_\_\_\_\_  
 No. of Heat Zones 1 Hot Water: (One Pipe \_\_\_\_\_ Two Pipe \_\_\_\_\_ Series Loop \_\_\_\_\_) Electric Heat: (No. of Circuits \_\_\_\_\_) No. of Furnaces 1  
 No. of Hot Air Runs 12 No. of Hot Water Radiators \_\_\_\_\_ Total Heat Loss 75,000 Rated Capacity of Furnace/Boiler 90,000  
 Location of Heating Units: Crawl Space \_\_\_\_\_ Floor Level  Attic \_\_\_\_\_ Suspended \_\_\_\_\_ Roof \_\_\_\_\_ Outside \_\_\_\_\_ Other \_\_\_\_\_  
 Description of Work New

**DRAWINGS REQUIRED:** All Applications must be Accompanied by Two Complete sets of Drawings Including SITE PLAN, FOUNDATION PLAN, FLOOR PLANS, STRUCTURAL FRAMING PLANS, EXTERIOR ELEVATIONS, SECTIONS and DETAILS, STAIR DETAILS, ELECTRICAL LAYOUT, PLUMBING ISOMETRIC, HEATING LAYOUT ETC. All plans shall be DRAWN TO SCALE. Show all existing structures on the site plan also, show Electric Panel and Furnace Locations.

**READ AND SIGN BELOW;** The undersigned hereby makes application for a permit for all work described herein, and agrees to complete the work in strict accordance with all applicable provisions of the current edition of the C.A.B.O. Building Code, the Napoleon Building and Zoning Codes, the Napoleon Engineering Dept. Rules and Regulations, Standard Specifications and other Pertinent Sections of the Napoleon Code of Ordinances.

Date 9/12/91 Signature of Applicant Robert S. [Signature]  
 Application not valid without signature



SEC. JUNCTION BOX



INSTALL 4/0  
DB URD CABLE

60'

10'

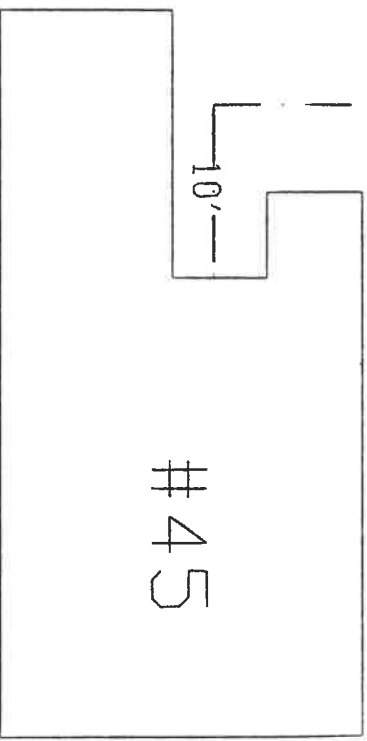

#45

*Jana*

- 85' 4/0 DB URD CABLE
- 10' 2" PVC CONDUIT
- 1 2' PVC BOX CONNECTOR

45-LEM

501038

LEMANS DR.

DUQUESNE

11-08-91

DUPS#1108MSS23

